

Import Belgium & Luxembourg

Profilex s.a.

4A, Z.I. In den Allern
L-9911 Troisvierges

Tel: 00352/99 89 06
Fax: 00352/26 95 73 73

www.profilex-systems.com

profilex@pt.lu

7

TOOLS + PROCESSING SERVICES

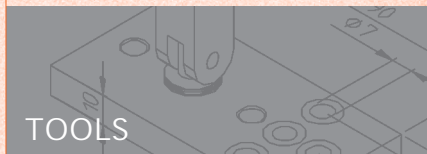

BALL-HEADED KEY

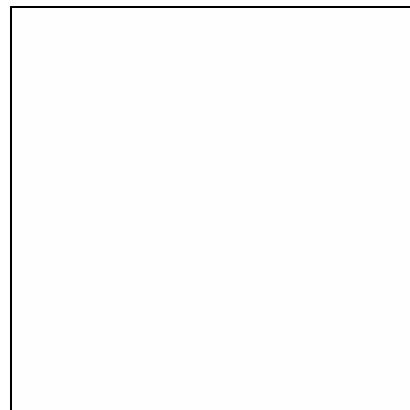
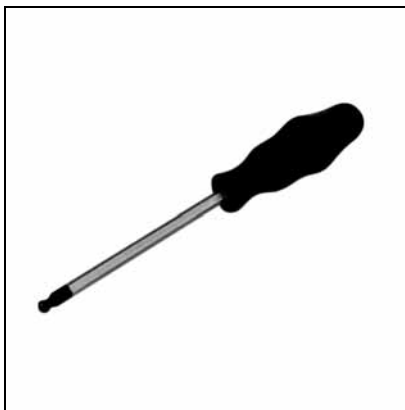
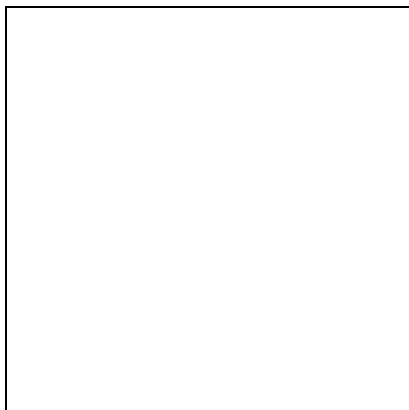

TECHN. DATA / ITEMS SUPPLIED

- Chrome plated, with handle PA GF, green

APPLICATIONS

- Pretightening of MiniTec power-lock fastener

OTHER DESIGNS

- BALL-headed key 4 A/F
Part N° 26.1817/0

- BALL-headed key 5 A/F
Part N° 26.1084/0

- Pretightening of bolt- and butt- fasteners

T-HANDLE KEY

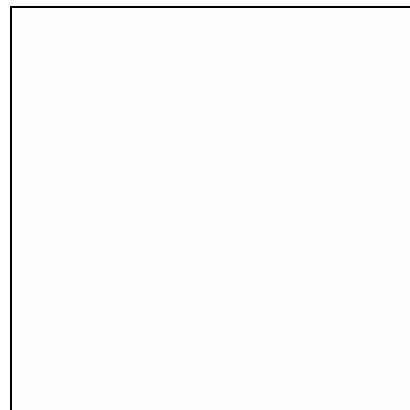
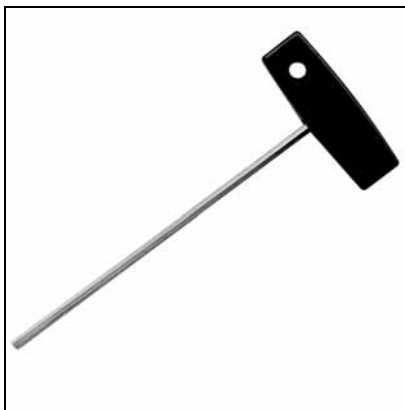
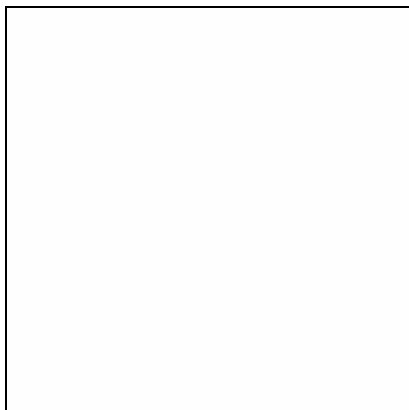

TECHN. DATA / ITEMS SUPPLIED

- Chrome plated

- Handle, PA GF, black

APPLICATIONS

- Tightening of MiniTec power-lock fastener

OTHER DESIGNS

- T-handle key 4 A/F
Part N° 26.1810/0

- T-handle key 5 A/F
Part N° 26.1083/0

COMBI L-KEY

Part. N°

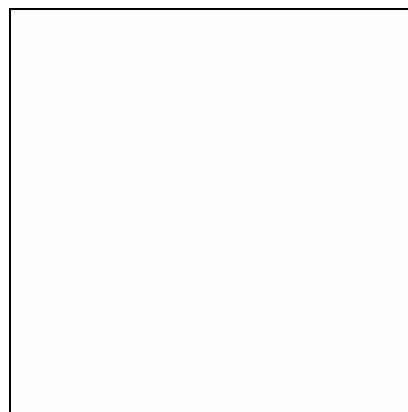
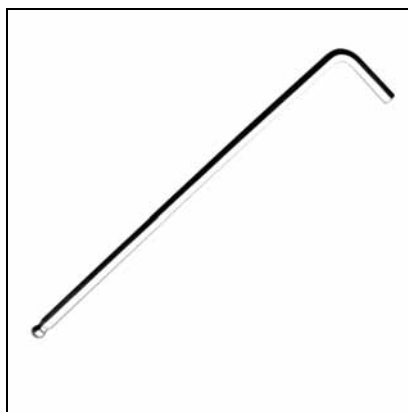
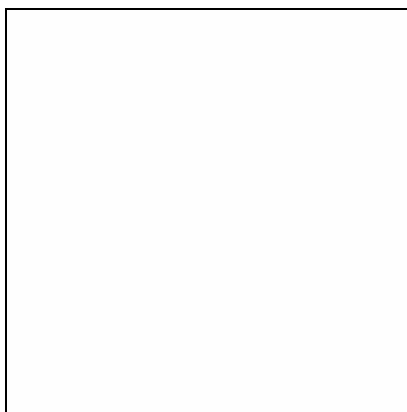

TECHN. DATA / ITEMS SUPPLIED

- Chrome plated, one end ball headed

APPLICATIONS

- Pretightening and final tightening of MiniTec power-lock fastener

OTHER DESIGNS

- Combi L-key 4 A/F Part N° 26.1811/0

- Combi L-key 5 A/F Part N° 26.1085/0

- Pretightening of hex socket cap screws and counter sunk screws M8

T-HANDLE KEY TORX T40

Part. N° 26.1814/0

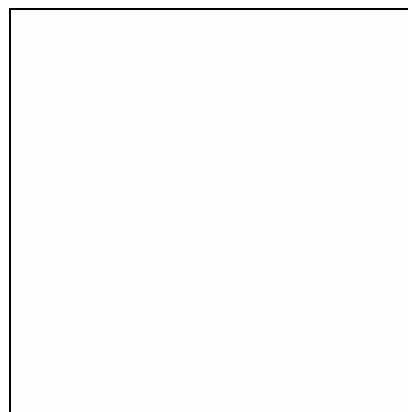
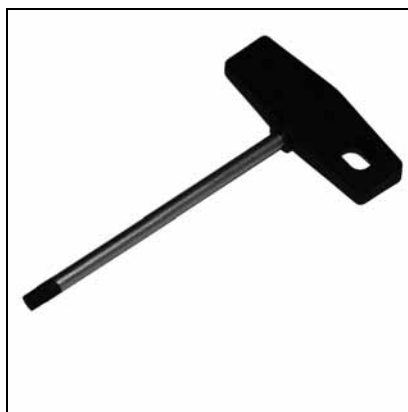
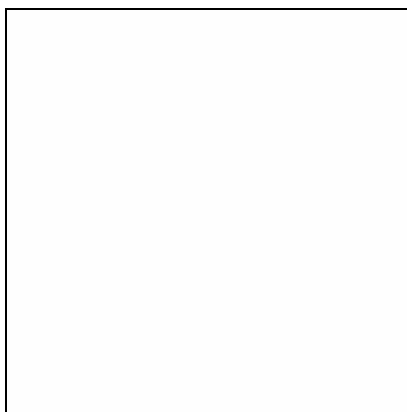

TECHN. DATA / ITEMS SUPPLIED

- Chrome plated

- Handle, PA GF, black

APPLICATIONS

- Pretightening and final tightening of MiniTec power-lock fastener SF and ESDSF

OTHER DESIGNS

MAGNETIC BIT HOLDER TORX

Part. N° 26.1820/0

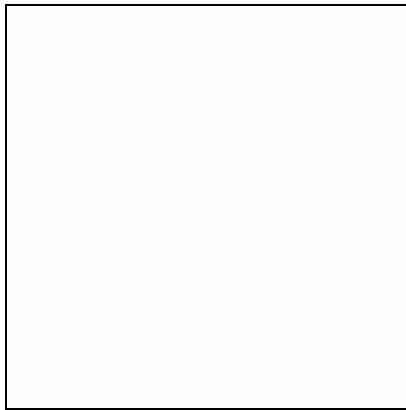

TECHN. DATA / ITEMS SUPPLIED

- Automatic holder with strong permanent magnet

APPLICATIONS

- Receptacle for bits Torx 40 for self-forming screws M8 of MiniTec Power-lock fastener

APPLICATIONS

- Retains the screws optimal on the tool in every position even at high revolution speed

DRILLING JIG

Part. N° 26.1092/0

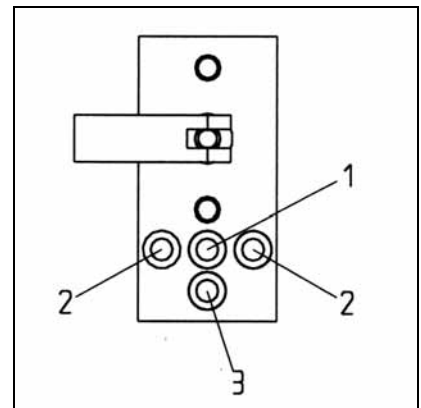
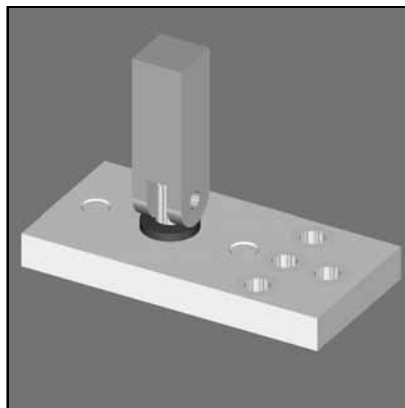
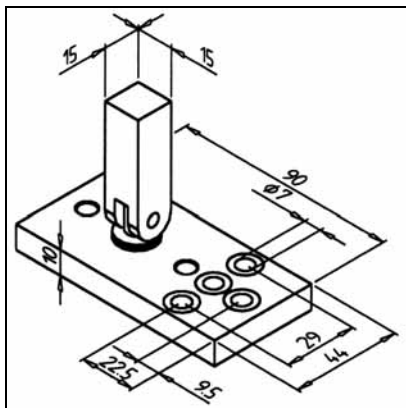

TECHN. DATA / ITEMS SUPPLIED

- Aluminium
- Steel drill bushes Ø 7 mm
- Eccentric clamp device
- Weight 0,220 kg

APPLICATIONS

- Positioning of step drilling for screw-connection
- Precise positioning of drillings for pneumatic connections on profile surface
- Screw connection of profiles 32 x 32

ASSEMBLY

- Clamp drilling jig on profile groove and bore through bushes

DRILLING JIG FOR MITRE-CONNECTOR

Part. N° 26.1050/0

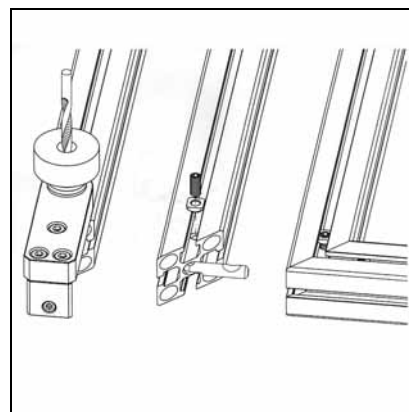
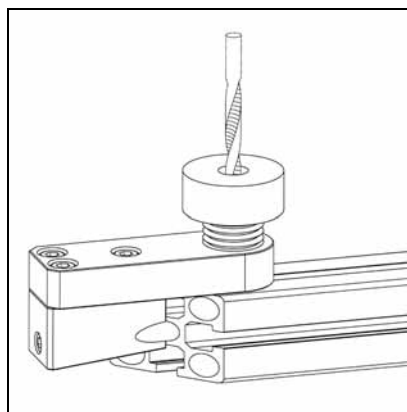
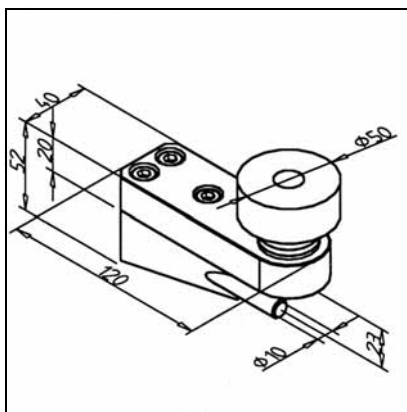

TECHN. DATA / ITEMS SUPPLIED

- Body: Al, anodized
- Centering pin: steel
- Fixing-screw: plastic with steel bush
- Weight 0,450 kg

APPLICATIONS

- Positioning of bore for set screw of mitre connector in relation to mitre angle
- Suitable for all MiniTec profiles

ASSEMBLY

- Cut profile in desired angle, rebore the center-bore $\varnothing 7,3$ mm to $\varnothing 10,2$ mm
- Insert pin into center bore and fix plastic clamp screw
- Drill bore $\varnothing 8,0$ mm through drilling jig in fixing screw
- Tighten mitre-connector with set screw M8

DRILLING JIG FOR MITRE-CONNECTOR N

Part. N° 26.1060/0

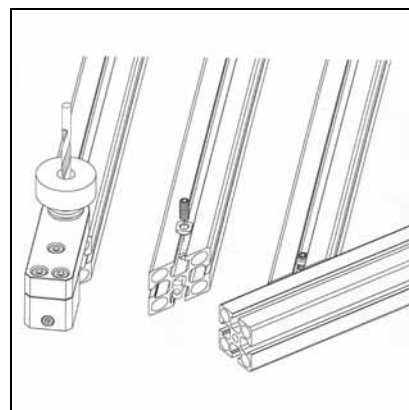
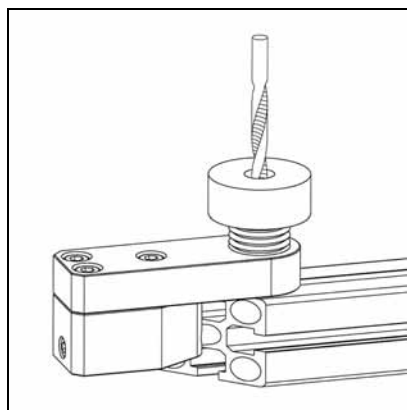
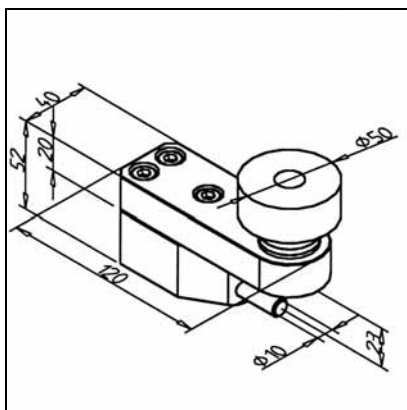

TECHN. DATA / ITEMS SUPPLIED

- Body: Al, anodized
- Centering pin: steel
- Fixing-screw: plastic with steel bush
- Weight 0,556 kg

APPLICATIONS

- Positioning of bore for set screw of mitre connector N in relation to mitre angle
- Suitable for all MiniTec profiles

ASSEMBLY

- Cut profile in desired angle, Rebore center-bore to $\varnothing 10,2$ mm
- Insert pin into center bore and fix plastic clamp screw
- Drill bore $\varnothing 8,0$ mm through drilling jig in fixing screw
- Tighten mitre-connector with set screw M8

THREAD FORMER M8

Part. N° 26.1082/0

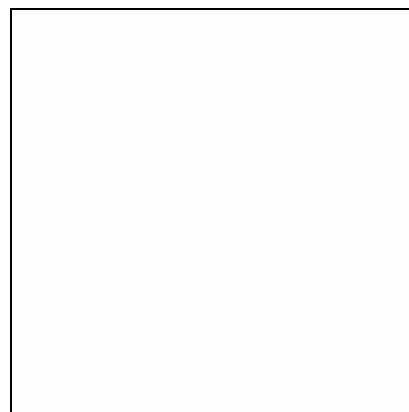
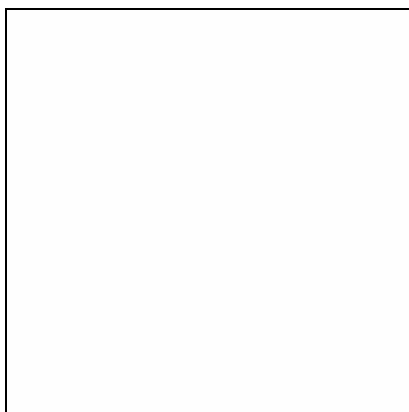

TECHN. DATA / ITEMS SUPPLIED

- HSS-E	
- Length:	95 mm

APPLICATIONS

- Roll-tap forming of M8 threads in core bores of all profiles

ASSEMBLY

TORX BIT T 40 X 25

Part. N° 26.1822/0

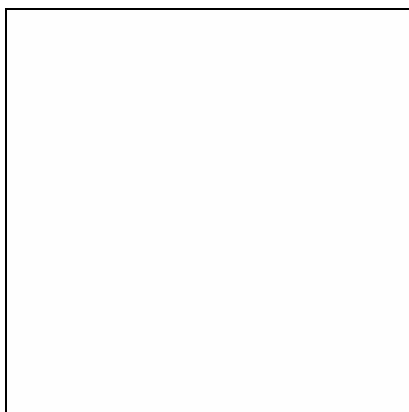

TECHN. DATA / ITEMS SUPPLIED

- Steel, hardened	
-------------------	--

APPLICATIONS

- Adapted to self-forming screws M8 for MiniTec power-lock fastener

ASSEMBLY

STEP DRILL 10,1

Part. N° 26.1816/0

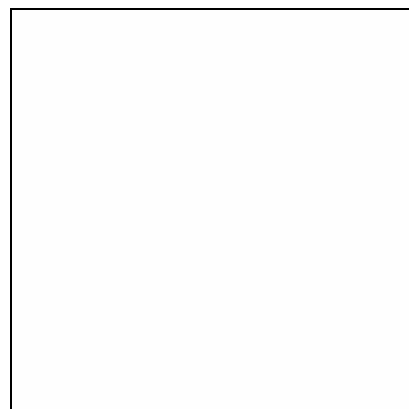
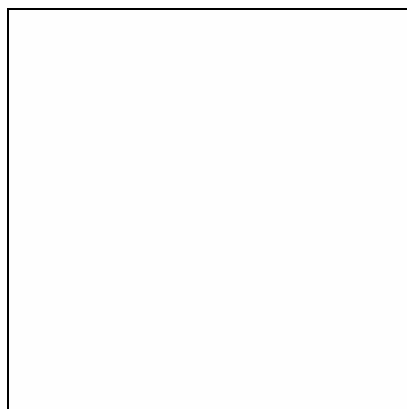
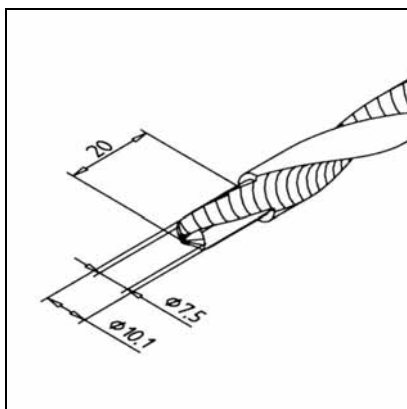

TECHN. DATA / ITEMS SUPPLIED

- HSS-steel
- Steps Ø 7,5 mm, 20 mm
- Shaft cylindric
- Length: 132 mm

APPLICATIONS

- Step drilling for mitre connector and mitre connector N

ASSEMBLY

STEP DRILL 15

Part. N° 26.1815/0

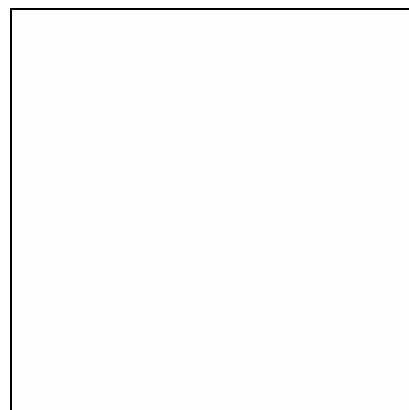
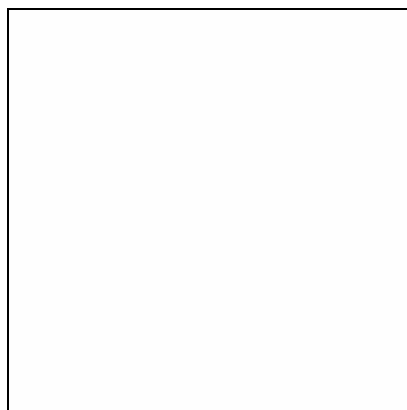
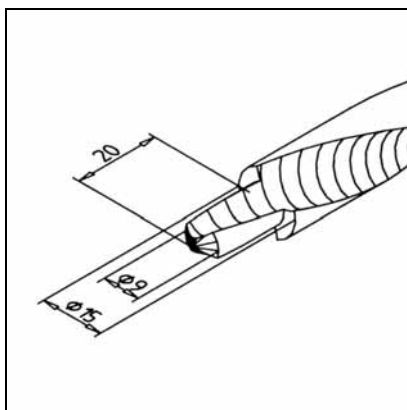

TECHN. DATA / ITEMS SUPPLIED

- HSS-steel
- Steps Ø 9 mm, 20 mm
- Shaft cylindric
- Length: 165 mm

APPLICATIONS

- Step drilling for bolt- and butt-fastener

ASSEMBLY

STEP DRILL 20

Part. N° 26.1813/0

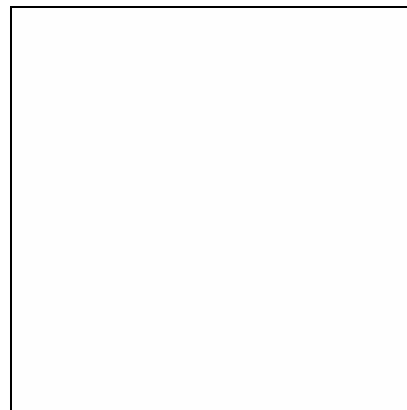
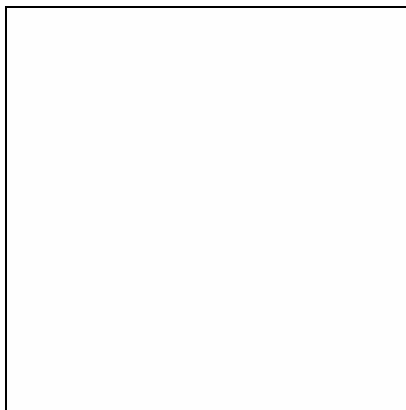
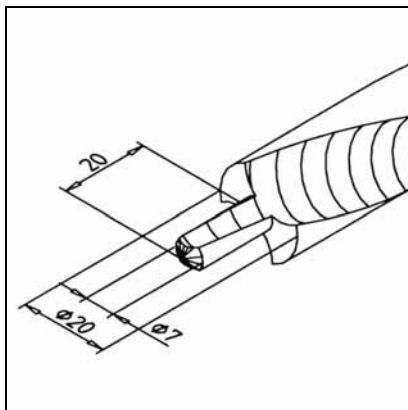

TECHN. DATA / ITEMS SUPPLIED

- HSS-steel
- Steps Ø 7 mm, 20 mm
- Shaft cylindric
- Length: 238 mm

APPLICATIONS

- Step drilling for bolt- and butt-fastener

ASSEMBLY

THREAD FORMING MACHINE

Part. N° 26.1910/0

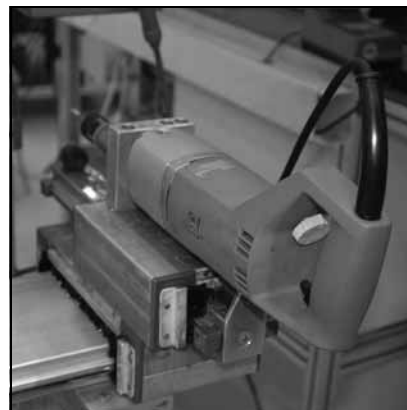
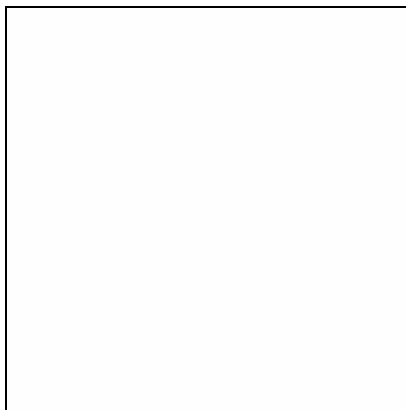
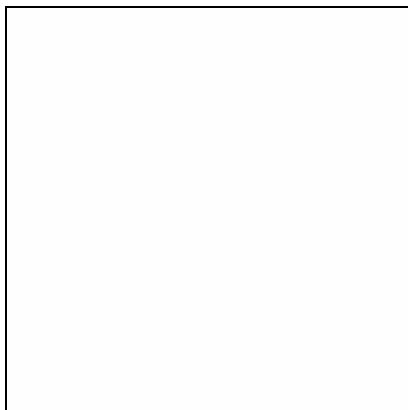

TECHN. DATA / ITEMS SUPPLIED

- Automatic changing of turning direction, quick reverse movement 230 V, 650 W
- For threads up to M12
- Complete with chuck
- Spindle housing: Ø 38,1 mm
- Weight 2,300 kg

APPLICATIONS

- Cost effective forming of threads in core bores of profiles, To be used together with thread forming jig

ASSEMBLY

AUTOMATIC THREAD FORMING DEVICE

Part. N° 26.1970/0

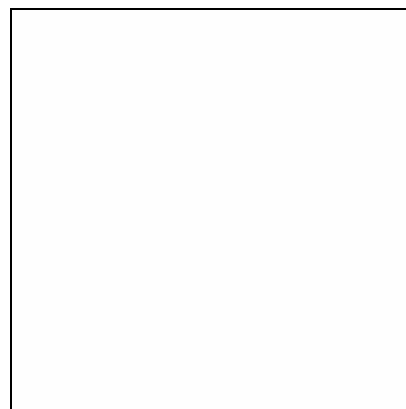
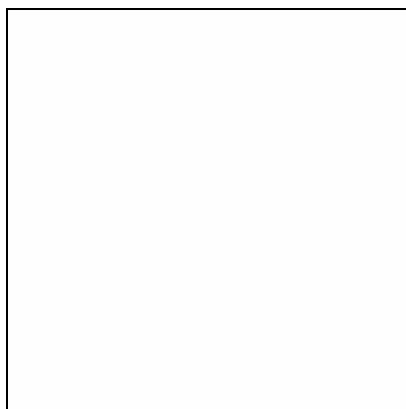
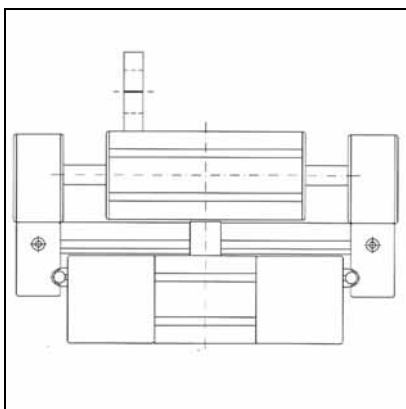

TECHN. DATA / ITEMS SUPPLIED

- Made of MiniTec aluminium profiles
- 2-axis slide with machine seating for thread forming or drilling machines with spindle housing Ø 38,1 mm
- Complete with support frame
- Without machine

APPLICATIONS

- Rational thread forming
- Rational re boring of central bores
- Can be delivered with 1 - 4 slides for up to 4 machines

APPLICATIONS

TEAR-OFF LEVER

Part. N° 26.0815/0

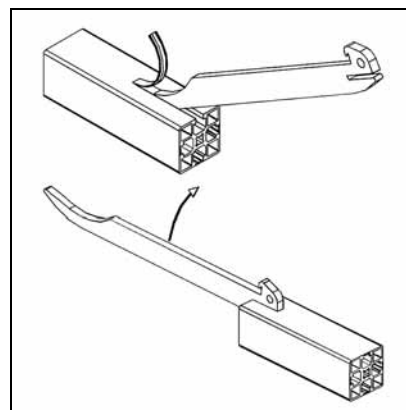
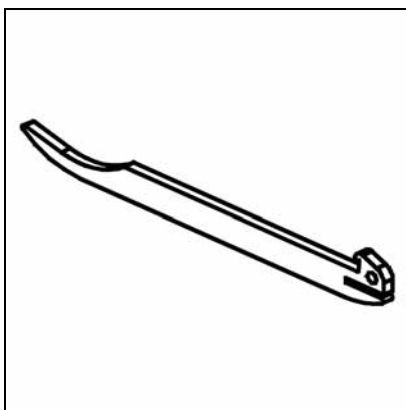

TECHN. DATA / ITEMS SUPPLIED

- Steel, chrome plated
- Weight 0,456 kg

APPLICATIONS

- Rational opening of the MiniTec aluminium profiles G groove covers, e.g. for the installation of panel elements, attachment of linear guides etc.
- Rational opening of the MiniTec aluminium profiles G groove covers for the assembly of MiniTec power-lock fastener

APPLICATIONS

- Slick the slot end of the tool at the profile end on the groove cover and break it open towards the top; break off the groove cover by pulling up and down
- The produced opening is designed for the assembly of MiniTec power-lock fasteners. After tightening cut out is covered with a end cap G Part N° 22.1056/0
- Slick bended end under the groove cover and open in desired length. Opened grooves can be covered again with cover profiles

DEBURRING TOOL

Part. N° 26.0813/0

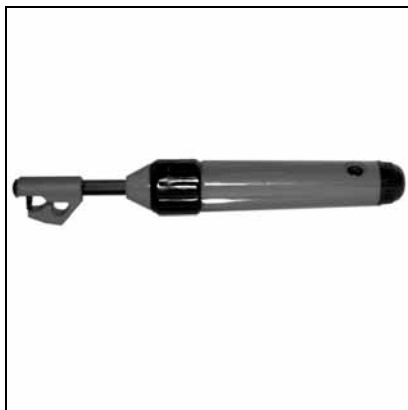

TECHN. DATA / ITEMS SUPPLIED

- Plastic handle
- Changable
- Weight 0,090 kg

APPLICATIONS

- For deburring of the profile groove after opening the grooves of profiles G
- For deburring of bores

ASSEMBLY

- Set tool and slide along area to be deburred

TEAR-OFF PLIERS FOR G PROFILES

Part. N° 26.0814/0

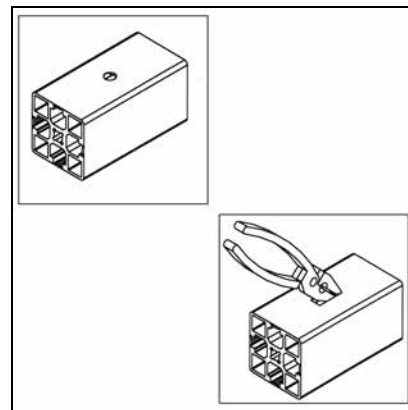
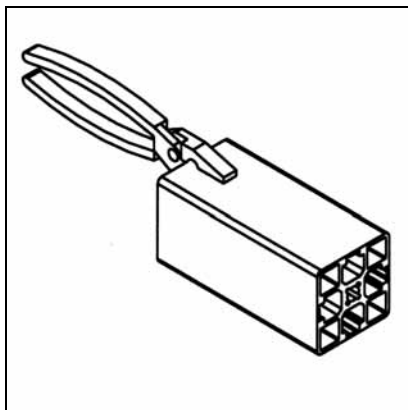

TECHN. DATA / ITEMS SUPPLIED

- plastic handle
- Weight 0,150 kg

APPLICATIONS

- For opening the profile grooves of MiniTec profiles G groove covers

ASSEMBLY

- Set pliers onto profile cover and break by swivelling several times

ANODISING POLISHER

Part. N° 26.0811/0

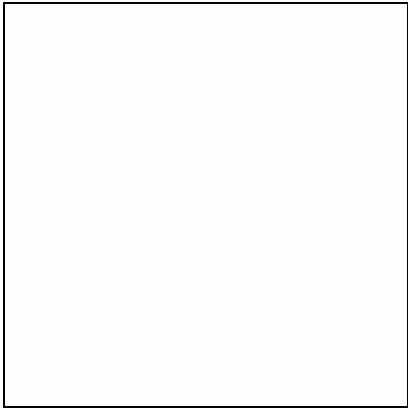
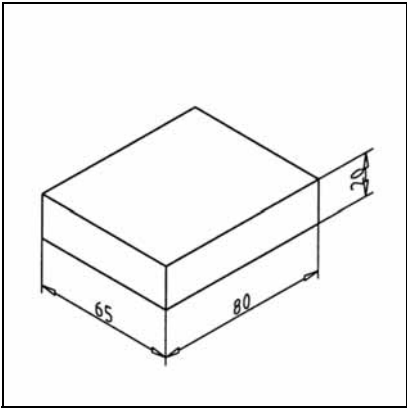

TECHN. DATA/ITEMS SUPPLIED

- elastic abradent
- Weight 0,138 kg

APPLICATIONS

- to remove minor scratches on anodic coating
- to equal "shades" on anodic coating

ASSEMBLY

- also suitable for hard-to-reach positions (eraser can be cut to size)
- usable wet and dry - water intensifies the effect
- even polished sections without physical effort
- water- and oil-resistant
- ecofriendly, no detergents necessary
- long-life

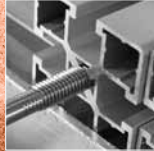

PROCESSING SERVICES

PROCESSING SERVICES

The MiniTec profile system requires minimum of processing. Saw cutting and thread-forming are the essential processes, only in exceptional cases is drilling required.

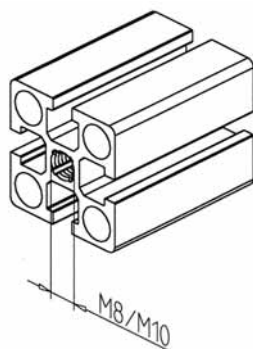

Thread M8 M10

Thread M8 x 20
in core bore
for power-lock fastener

Part N° 25.1087/0

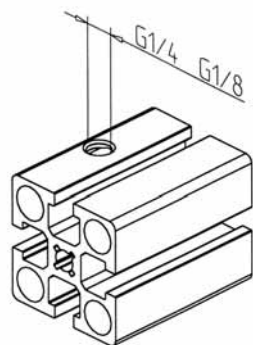

Thread G1/4 G1/8

Thread M10 x 25
in core bore for feet

Part N° 25.1088/0

Thread G 1/4
on profile surface
for pneumatics

Part N° 25.1089/0

Thread G 1/8
on profile surface
for pneumatics

Part N° 25.1090/0

Thread G 1/4
in core bore Ø 11,7 mm
for plug, pneumatics

Part N° 25.1091/0

Through bore Ø 7 mm
for screw connection

Part N° 25.1092/0

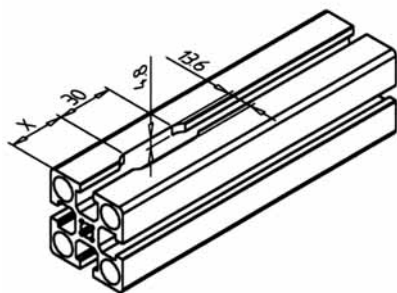

Processing Insertion tide

Insertion tide
on profile surface for subsequent
insertion of power-lock fastener

Part N° 25.0315/0

Step bore Ø9 / Ø15
for bolt and butt fastener 15

Part N° 25.1085/0

Step bore Ø7 / Ø20
for bolt and butt fastener

Part N° 25.1097/0

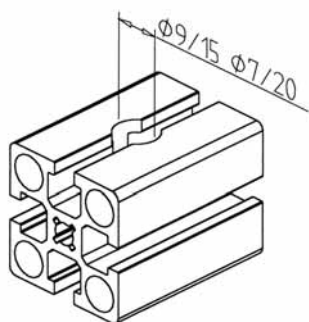

Step bore

Processing for mitre connections
for mitre connector
(without cut)

Part N° 25.1072/0

Mitre cut
for mitre connector
(see section fastening elements/
mitre connector)

Part N° 25.1072/1

PROFILE BENDING

New applications thanks to bent profiles:

- Decorative structures for exhibitions or office furniture
- Functional designs for swivelling constructions,
- Machine guards exactly suited to the machine-shape
- Security-fences
- Curved roller-conveyors
- Holders e.g. for lamps in workstations

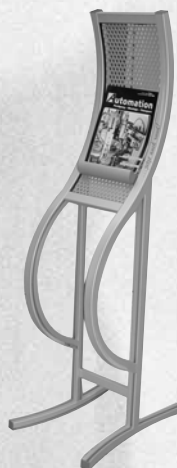

Technical features



For standard-applications no subsequent anodizing is necessary. However there will occur small visible cracks in the anodized layer in the bended area. For high optical demands subsequent anodizing of the bended profiles is necessary.

The grooves of the bended profiles do not change with the process. But power-lock fasteners require a minimum radius of 400 mm.

G-Type profiles and UL- profiles are not appropriate for bending.

Thanks to the CNC-Control of our high performance bending machine various radii on the same bar are possible.



Profile	Position	min. Radius
P 19 x 45 and P 45 x 19		R 250 R 1000
P 19 x 32		R 200 R 300
P 32 x32 F		R 300
P 45 x 32 F		R 350 R 400
P 45 x 45 F and P 45 x 45		R 400
P 45 x 90		R 500 R 1000